



CSYNC™ AUTOINJECTOR

COPAXONE®
(glatiramer acetate injection)

- EN** Please read these instructions for use even if you have used other autoinjector devices.
- DE** Bitte lesen Sie diese Bedienungsanleitung durch, auch wenn Sie bereits andere Autoinjektionsgeräte verwendet haben.
- FR** Veuillez lire ces instructions d'utilisation même si vous avez utilisé d'autres dispositifs d'auto-injection.
- ES** Lea estas instrucciones de uso aunque haya utilizado otros dispositivos autoinyectores.
- IT** Si prega di leggere le istruzioni per l'uso, anche se ha già usato in precedenza altri dispositivi di autoiniezione.
- NL** Lees deze instructies voor het gebruik, zelfs als u gebruik maakt van andere auto-injectorinstrumenten.
- PT** Leia estas instruções de utilização mesmo que já tenha utilizado outros dispositivos autoinjeter.
- NO** Det er viktig at du leser igjennom denne instruksjonen før du tar i bruk autoinjektoren, selv om du har brukt en annen autoinjektor.
- SV** Läs igenom dessa anvisningar även om du har använt andra typer av autoinjektorer.
- FI** Lue nämä käyttöohjeet, vaikka olisit käyttänyt muita autoinjektoreita.
- DA** Læs denne brugsanvisning, selvom du før har brugt andre autoinjektorer
- IS** Lestu þessar notkunarlaiðbeiningar jafnvel þótt þú hafir áður notað sjálfvirkan inndælingarbúnað.

- EL** Διαβάστε αυτές τις οδηγίες χρήσης ακόμη κι αν έχετε χρησιμοποιήσει άλλες συσκευές αυτόματης ένεσης.
- CZ** Přečtěte si prosím tento návod k použití i v případě, že jste již dříve používali jiný auto-injektor.
- HU** Kérjük, akkor is olvassa el ezt a használati útmutatót, ha már használt más öninjekciós eszközt.
- BG** Моля, прочетете тези инструкции за употреба, дори ако сте използвали други автоинжектори.
- ET** Lugege kasutusjuhendit isegi siis, kui olete varem kasutanud teisi automaatseid süsteseadmeid.
- LV** Lūdzu, izlasiet šo lietošanas pamācību pat, ja esat lietojis citas automātiskas injekcijas ierīces
- LT** Perskaitykite šias instrukcijas, net jei teko naudoti kitokius automatinius injektorius.
- RO** Vă rugăm citiți aceste instrucțiuni pentru utilizare, chiar dacă ați utilizat alte dispozitive de autoinjectare.
- SK** Tento návod na použitie si prečítajte aj v prípade, ak ste používali iné pomôcky na automatické vstrekovanie.
- SL** To navodilo za uporabo preberite, tudi če ste že uporabljali druge pripomočke za samodejno injiciranje.
- HR** Molimo vas da pročitate ove upute za uporabu čak i ako ste već koristili druge uređaje za autoinjektiranje.
- PL** Proszę przeczytać poniższe instrukcje również wtedy, gdy użytkownik ma doświadczenie w korzystaniu z innych aplikatorów do iniekcji.

Step 1:

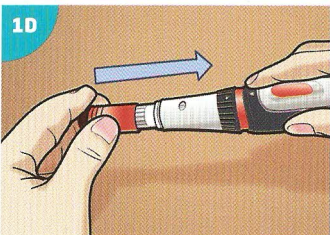
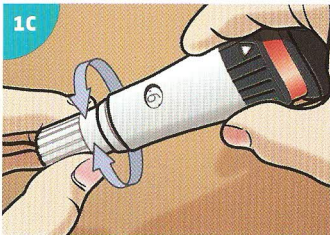
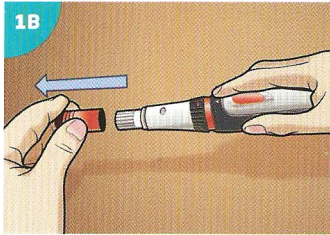
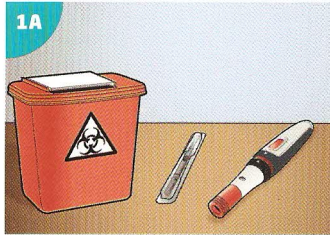

Step 2:

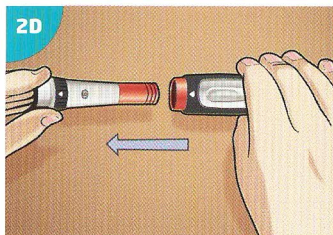
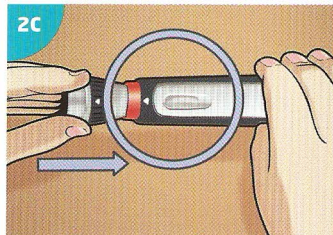
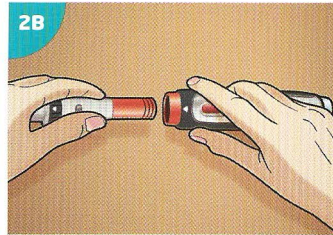
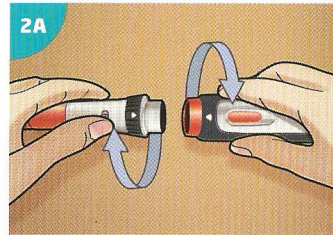

Step 3:

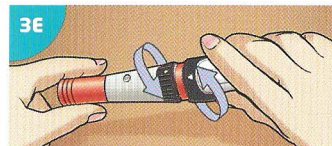
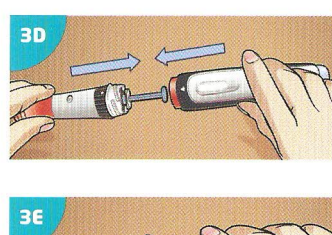
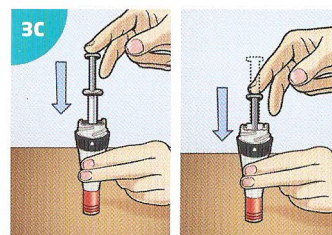
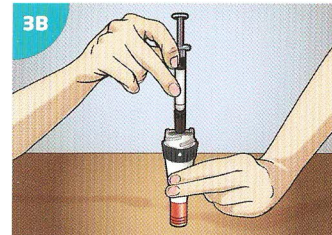
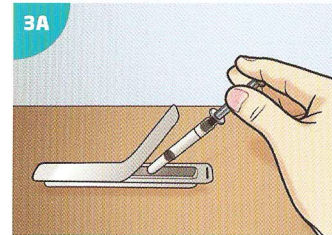

Step 4:

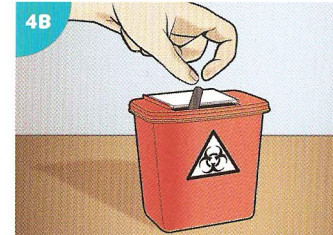
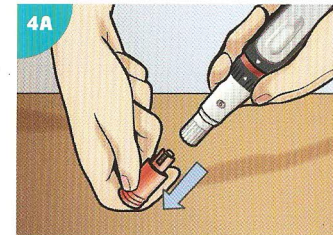

Step 5:

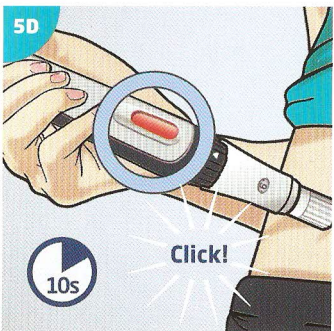
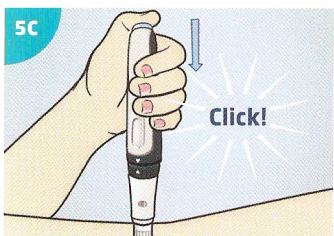
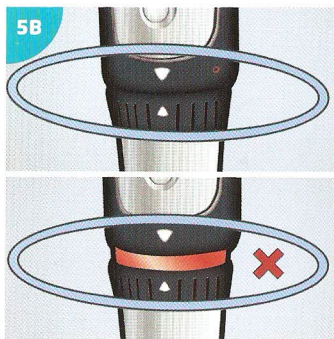
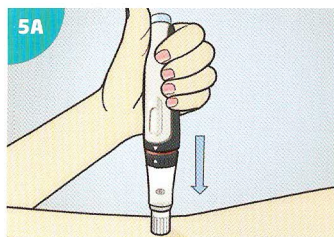

Step 6:

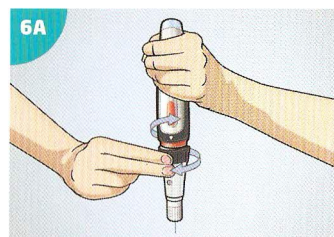

Step 7:

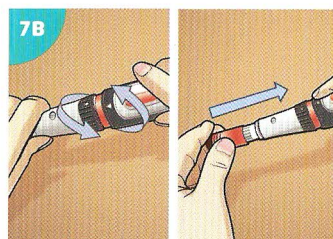

CSYNC™ AUTOINJECTOR

INSTRUCTION MANUAL

Introduction

NOTICE

CSYNC™ Autoinjector is designed to be used with COPAXONE® (glatiramer acetate) Prefilled Syringes.

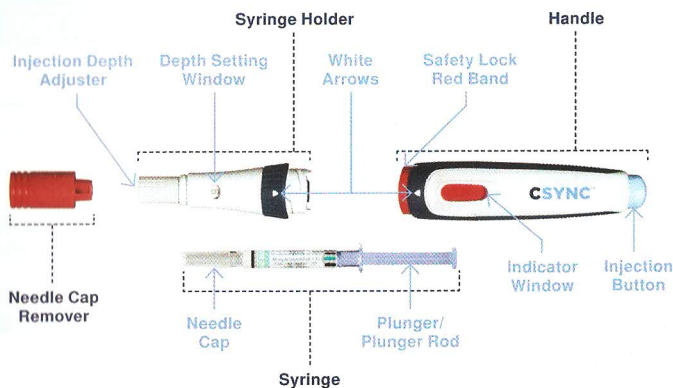

Important:

- ▲ Do NOT share your CSYNC™ Autoinjector with other people.
- ▲ Do NOT operate CSYNC™ Autoinjector without a syringe or with an empty syringe, as damage could occur to the autoinjector.
- ▲ Following insertion of the syringe, do NOT attempt to remove the red needle cap remover unless the device is fully assembled.
- ▲ Do NOT attempt to replace red needle cap remover following the injection when a syringe remains within the device.

NOTICE

Refer to the COPAXONE® (glatiramer acetate) package leaflet for patient support information and to learn how to use COPAXONE® (glatiramer acetate).

EN

DE

FR

ES

IT

NL

PT

NO

SV

FI

DA

IS

EL

CZ

HU

BG

ET

LV

LT

RO

SK

SL

HR

PL

Step 1: Set the depth adjuster

- 1A Place each of the items you will need onto a clean, flat surface in a well-lit area:
- ▲ CSYNC™ Autoinjector
 - ▲ COPAXONE® (glatiramer acetate) Prefilled Syringe
 - ▲ Sharps Container
- 1B Firmly grasp and pull the red needle cap remover from the autoinjector and set the remover aside for later use.
- 1C Set the needle depth by turning the gray injection depth adjuster until the setting suggested by your healthcare professional appears in the depth-setting window.

NOTICE Smaller number indicates a shallower injection, and a higher number indicates a deeper injection.

- 1D Push the red needle cap remover onto the autoinjector until it clicks securely into place.

NOTICE Do NOT proceed to step 2A without replacing the red needle cap remover.

Step 2: Prime the device

- 2A Unscrew the syringe holder from the handle.
- 2B Turn the syringe holder so that the red needle cap remover faces the open end of the handle.
- 2C Push the syringe holder into the handle until you feel and hear the device lock into position. The indicator window will change from red to white.
- 2D Pull the syringe holder from the handle.

NOTICE Do NOT proceed to step 3A if the indicator window is red.

Step 3: Insert the syringe

- 3A Remove the syringe from its protective blister pack. Do NOT remove the syringe needle cap.
- 3B Placing the syringe holder facing downward on a firm, flat surface, insert the needle-capped end of the syringe into the syringe holder.
- 3C Firmly push the syringe into the syringe holder by pressing on the top of the syringe plunger rod until the syringe cannot move any further. The syringe is now correctly loaded.

WARNING Do NOT remove the red needle cap remover until step 4A.

- 3D Insert syringe holder into handle.
- 3E Screw the syringe holder and the handle together until you hear a click and the white arrows align.
- 3F Once the syringe is loaded and the autoinjector is fully assembled, you are ready to start the injection process.

Step 4: Remove the needle cap

- 4A While firmly holding the CSYNC™ Autoinjector in one hand, firmly grip and pull the red needle cap remover away from the CSYNC™ Autoinjector with your other hand.
- 4B This will remove the needle cap from the syringe. Dispose of needle cap into a suitable container.

WARNING Please do NOT place the red needle cap remover back on the autoinjector. **Save** the red needle cap remover for future use.

Step 5: Inject the dose

NOTICE Refer to the COPAXONE® (glatiramer acetate) package leaflet to learn how to use COPAXONE® (glatiramer acetate), as well as for information on the recommended injection sites.

- 5A Gently press the gray tip of the CSYNC™ Autoinjector onto the prepared injection site. Make sure that the indicator window is visible so that you can check when the injection is complete.
- 5B To release the safety lock, push down on the handle until the white arrows meet and the red band is hidden.

NOTICE If the red band is still showing, device will not activate.

NOTICE Read BOTH steps 5C and 5D before proceeding.

- 5C Holding the CSYNC™ Autoinjector steady, push the blue injection button to start the injection. You will hear the first click when the injection starts.
- 5D Hold the autoinjector on the injection site until you hear a second click and the indicator window turns red (approximately 10 seconds).
- 5E Remove the CSYNC™ Autoinjector from the injection site. Press a dry cotton ball on the injection site for a few seconds.

WARNING The needle will be exposed after the injection. Do NOT put your fingers near the end of the autoinjector.

Step 6: Remove and dispose of the syringe

- 6A Grip the syringe holder with the exposed needle facing downwards. Unscrew the handle.
- 6B Gently tip the syringe holder to allow the syringe to fall into a sharps container.

WARNING Care should be taken to avoid any exposed needle tip to prevent accidental injury. If you did NOT receive the full dose and see leftover medication in the used syringe, contact your healthcare professional. Do NOT reinject with a new syringe or with the syringe that was just removed.

6C As local laws for disposal of syringes and needles vary, check with your healthcare professional about the correct way to dispose of used syringes in your area. Do NOT throw them into a garbage or recycling bin.

Step 7: Clean and store your CSYNC™ Autoinjector

NOTICE Do NOT immerse your CSYNC™ Autoinjector in water.

7A Wipe the external components and the accessible areas of the syringe holder with a clean, damp cloth after every use.

7B Screw the syringe holder and the handle back together. Push the red needle cap remover onto the autoinjector until it clicks securely into place.

NOTICE Do NOT proceed to step 7C without replacing the red needle cap remover.

7C Store your device safely in the wallet provided.

WARNING Do NOT place device in the refrigerator.



Made in England by Owen Mumford Ltd, Brook Hill, Woodstock, Oxfordshire, OX20 1TU United Kingdom



For LOT number and date of manufacture, please refer to the regulatory tag.

COPAXONE® (glatiramer acetate) is a registered trademark of Teva Pharmaceutical Industries Ltd. and is used under license.

CE
0120

Rev. 07/2014

AJ/1184/11/0366/01